

Model ECM24N Controller Exploded Diagram

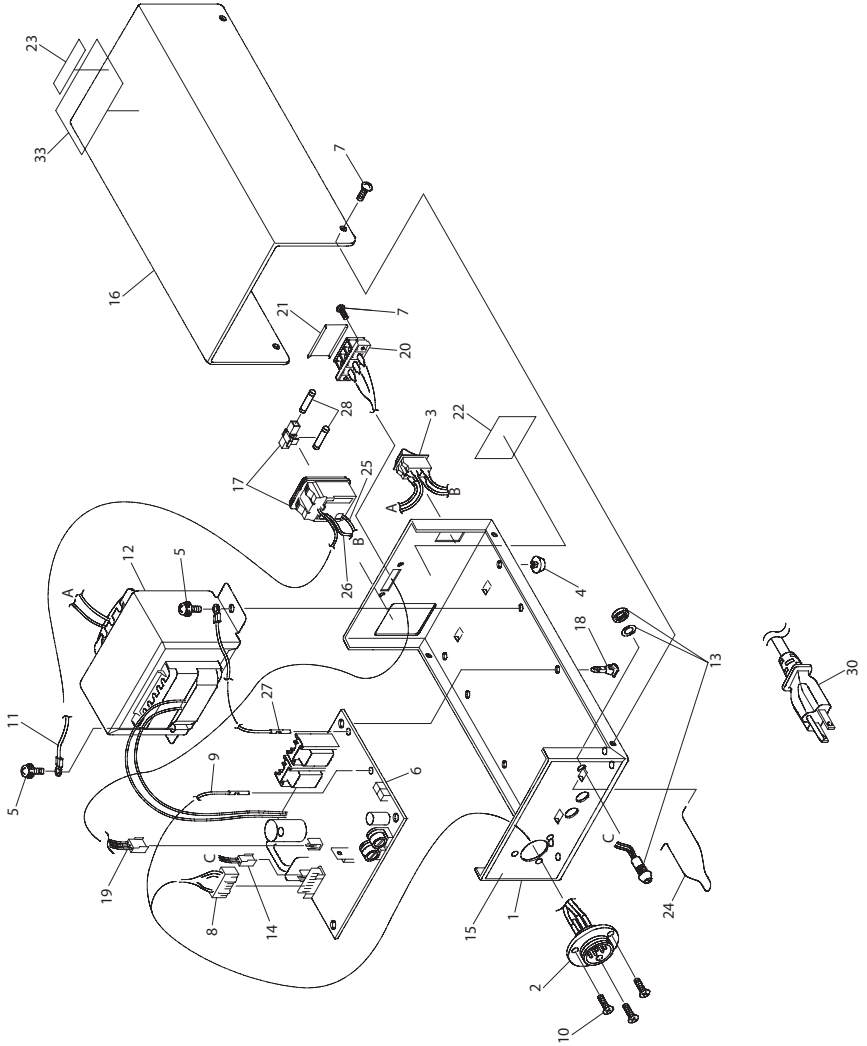

(Dwg. 45574639)



Model ECM24N Controller Parts List

Item	Part Description	Part Number	Item	Part Description	Part Number
1	Chassis	TV03752	16	Cover	TV03753
2	Receptacle	TV03755	17	Inlet	TV03198
3	Power Switch	TV03205	18	Spacer (4)	TV03201
4	Rubber Foot (4)	TV03202	19	Socket Assembly	TD03441
5	Screw (M4 x 6) (2)	TV03203	20	Terminal Block	TV03761
6	Control Base Assembly	TD03451	21	Cover for Terminal Block	TV03762
7	Tapping Screw (M3 x 10) (6)	TV01137	22	Model Label	ECM24N-301
8	Socket Assembly	TD03440	23	Label	TV03760
9	Wire Assembly	TD02681	24	Hook	TV03207
10	Tapping Screw (M3 x 8) (3)	TV03763	25	Wire Assembly	TD02884
11	Ground Wire Assembly	TD02886	26	Wire Assembly	TD02885
12	Transformer	TV05592	27	Ground Wire Assembly	TD02683
13	Pilot Lamp	TV01093	28	Fuse (250V, 1A)	TV03199
14	Socket Assembly	TD02887	30	Cord Assembly for F (UL3P Plug)	TD02957
15	Nameplate Label	ECM24N-300	33	Warning Label	ECM24N-99

Parts and Maintenance

When the life of the tool has expired, it is recommended that the tool be disassembled, degreased and parts be separated by material so that they can be recycled.

Tool repair and maintenance should only be carried out by an authorized Service Center.

Refer all communications to the nearest **Ingersoll Rand** Office or Distributor.

Related Documentation

For additional information refer to:

Product Safety Information Manual 16573701.

Product Information Manual 45549185.

Maintenance Information Manual 45549201.

Manuals can be downloaded from www.irtools.com.